

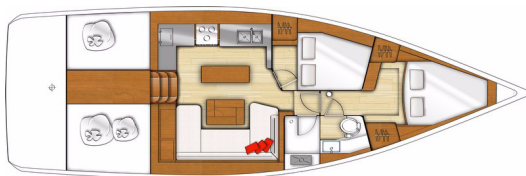

2 cabins - 1 Head version



## GENERAL SPECIFICATIONS

• L.O.A	13,20 m	43'4"
• Hull length	12,80 m	42'
• L.W.L.	11,95 m	39'2"
• Beam	4,28 m	14'1"
• Deep draught	2,10 m	6'11"
• Deep ballast weight	2 650 kg	5,842 lbs
• Shallow draught	1,75 m	5'9"
• Shallow ballast weight	2 925 kg	6,449 lbs
• Air draught	18,88 m	61'11"
• Light displacement (EC)	10 070 kg	22,201 lbs
• Fuel capacity (standard)	200 l	53 US Gal
• Fuel capacity (Optional equipment)	200 l	53 US Gal
• Freshwater capacity (standard)	515 l	136 US Gal
• Freshwater capacity (Optional equipment)	160 l	42 US Gal
• Engine power (HP)	54 HP Sail Drive	54 HP Sail Drive
• Engine power (POD)	POD 90	POD 90

## ARCHITECT / DESIGNERS

- Naval Architect : Berret Racoupeau Yacht Design
- Interior design : Nauta Design

## EC CERTIFICATE

- Category A - 6 persons
- Category B - 7 persons
- Category C - 10 persons

## STANDARD SAIL LAYOUT AND AREA

• Mainsail (classic)	45,20 m <sup>2</sup>	486 sq ft
• Genoa (105 %)	41,20 m <sup>2</sup>	443 sq ft
• Asymmetric spinnaker	106,00 m <sup>2</sup>	1,140 sq ft
• I	16,20 m	53'2"
• J	4,89 m	16'1"
• P	15,50 m	50'1"
• E	5,10 m	16'9"



## STANDARD EQUIPMENT

### CONSTRUCTION

- Design in accordance with European Directive requirements and according to EC certification
- Monolithic hull design in polyester
- Monolithic structural counter moulding laminated and bonded to the hull
- Deck in balsa and glass fibre sandwich covered in «diamond point» type non-slip surface
- Deck hull join banded and screwed, with 1 solid wood toerail
- Cast iron keel fixed with bolts and stainless steel backing plates
- Twin underhung rudders with stainless steel stock
- White coloured hull - Grey metallic livery

### DECK EQUIPMENT

#### RIGGING

- Standard mast SELDEN 9/10 electro-polished aluminium installed on the deck, 2 aft-swept spreaders - Slides
- Anodised aluminium boom
- Discontinuous stainless steel standing rigging
- Backstay: Bridle
- Rigid boom vang with tackle
- Genoa furling system with drum on the deck
- 2 Blocks "STANDUP" on mainsheet arch
- 2 genoa tracks with piston adjusted traveller cars - 2 Genoa sheet return blocks
- Rigging run back to cockpit (except boom topping lift)
- Complete running rigging: Main halyard, genoa halyard with clutch on mast and cleat, Boom topping lift with cleat on mast, Mainsheet, 2 Genoa sheets 2 rapid reefing lines
- 6 Jammers, and other control lines
- 2 rope boxes

#### WINCHES

- 2 Self-tailing genoa sheet winches (H46.2 STC)
- 1 Coach roof winch self tailing (H40.2 STC)
- 2 Winch handles SpeedGrip
- 2 Winch handle boxes

#### SAILS

- Furling genoa with UV protective strip DACRON
- Mainsail (classic) written semi battened DACRON
- Lazy Jack and Lazy Bag in Natural colour

#### MOORING LINES - MOORING

- Self-draining chain locker with eye bolt for bitter end
- 1 Opening access cover to chain locker
- Stainless steel bow fitting 1 Stem roller
- 12 V - 1000 W Vertical electrical windlass - Remote control
- 6 Stainless steel mooring cleats - Stainless steel deck line protection

#### SAFETY ON DECK

- 1 Open stainless steel forward pulpit - Step
- 2 fixed stainless steel pushpits
- Stainless steel backrests fitted to helm seats
- 1 Lifebuoy support bracket
- 1 Outboard engine bracket
- 1 Ensign staff
- Double guardrail and stainless steel stanchions - Opening to port and to starboard in guardrail
- 2 Stainless steel handrails on deck
- 2 Stainless steel handrails on fixed arch
- Transom protector for raising the tender

#### COCKPIT

- Self-draining cockpit
- 1 Port cockpit locker (Access to technical area)
- 1 Starboard cockpit locker (Access to technical area)
- 1 Gas locker beneath starboard cockpit seat
- Natural solid wood slatted cockpit benches
- 1 Liferaft locker in cockpit sole
- 2 Steering wheel consoles: Stainless steel steering wheels - 900 mm / 2'11" diameter - leather covered - Stainless steel handrail - navigation instrument support (optional instruments) - Glass holder - 2 Steering compass on binacle
- 3 Deck access points to tiller system
- 1 Tiller
- Engine throttle and control panel to starboard
- Wooden cockpit table with leaf to starboard which can be transformed into sun-bathing area
- 2 waterproof loudspeakers on fixed arch
- Cockpit lighting integrated in fixed arch
- 1 4-panel glazed saloon door

#### AFT TRANSOM

- Retractable transom to cockpit
- 2 Height-adjustable helmsman's seats
- Natural solid wood decking on sun deck
- 1 Stainless steel bathing ladder - solid wood steps - folds into locker
- 1 Shower cold water
- 1 Shore power socket
- 2 wet lockers on skirt

#### INTERIOR

- Fruitwood Alpi joinery
- White ceruse oak laminate flooring
- Fore hull and bulkhead covered with vinyl fabric ceiling
- Fabric upholstery in the saloon
- Marine mattresses in the cabins

#### COMPANIONWAY

- Headroom: 1,98 m / 6'6"
- Wooden companionway with cold-moulded 3 steps
- 2 Leather covered stainless steel handrails
- Glazed companionway hatch slides under the deck
- 2 Fixed deck windows



## SALOON

- Headroom: 1,95 m / 6'5"
- U shaped saloon bench
- Saloon table in 1 piece, Varnished wood top with inlay, Aluminium legs
- 1 central unit with folding bench seat - Stowage - Bar
- Shelves and stowage along the hull, Storage under bench seats
- 1 Hull porthole with curtain
- 1 Fitted deckhouse side window
- 1 Fixed wrap-around window to cockpit
- 1 flush deck hatch with blind / Mosquito net

## CHART TABLE

- Control console with flap - oddments locker - Storage - Moulded wood fiddle
- Navigator's seat with (15°) tilting cushion to compensate for heel
- Electrics panel
- Navigation instrument panel (without instruments)
- Battery switch panel + Breaker panel

## GALLEY

- Headroom: 1,95 m / 6'5"
- Lengthways kitchen
- Synthetic resin worktop
- 1 Sink with 2 rectangular bowls stainless steel
- 1 Mixer tap cold water / hot water
- 1 Gas cooker 2 burners, Stainless steel oven on mountings
- 1 Fridge 130 l, 12 V Refrigeration unit, front opening
- 1 Cool box 85 l, top opening
- Cupboards, Drawers and equipped lockers
- 1 Hull porthole with curtain
- 1 Fixed wrap-around window to cockpit

## FORWARD CABIN

- Headroom: 1,95 m / 6'5"
- Central double bed (2,10 x 1,55 m - 0,60 m / 6'11" x 5'1" - 2)
- Hanging locker, Cupboard, Shelving - Drawer - Mirror
- 1 Dorade (Ventilation)
- 2 Hull portholes with curtain
- 2 Opening deck hatches with blind / Mosquito net
- Private entrance to the starboard bathroom

## PORT CABIN

- Headroom: 1,95 m / 6'5"
- Double bed (1,97 x 1,43 m - 1,07 m / 6'6" x 4'8" - 3'6")
- Hanging locker, Cupboards, Lockers and cubby holes
- 1 Hull porthole with curtain
- 1 Fixed coachroof window + Curtain
- 1 Opening deck hatch with blind / Mosquito net

## HEAD VERSION

- Headroom: 1,95 m / 6'5"
- Separate moulded shower, shower mixer tap hot / Cold water, Shower screen
- Manual marine toilet
- Washbasin - Work top - Mixer tap hot water / Cold water
- 2 Mirrors
- Toilet accessories
- Cupboard and cubby hole
- 1 flush deck hatch with blind / Mosquito net
- 1 Coachroof windows with curtains

## ENGINE

- Engine Yanmar Diesel 54 hp / HP Sail Drive
- Engine control - Key ignition - Control panel in cockpit
- Engine compartment: Foam soundproofing - Ventilation: 1 air intake and 1 pressured air outlet
- 1 Alternator 12 V / 80 Ah
- 1 Rotomoulded diesel tank 200 L / 53 US Gal (Starboard cockpit locker) - Electronic gauge - Low level alarm - 1 Deck filler
- Filters: Sea water - Diesel - Decanter
- Fixed three blades propeller
- Engine access via companionway and machinery space

## ELECTRICITY

- 12 V circuit - 220 V circuit
- 2 service batteries (2x110 Ah) - 1 Engine battery (110 Ah)
- 1 25 Ah Battery charger - 1 220V shore power - 1 Power distributor
- Electrical panel (12 V / 220 V) (Circuit breakers - Voltmeter - Water gauge - Fuel gauge - Battery warning - Fuel warning)
- 2 220 V Sockets - 7 220 V Sockets
- Wire runs for options cables

## PLUMBING

- 2 Rotomoulded freshwater tanks (160 l / 42 US Gal Saloon - 330 L / 87 US Gal forward cabin) - Separate fillers - Tank selection with ¼ by-pass valves
- Pressurised electric water pump - Expansion tank - Inline filter
- 25 L / 7 US Gal Electric water heater (Operation off engine or on 220 V electrical system)
- 1 Rigid holding tank 80L / 21 US Gal
- Electrical shower drain pumps
- 2 Electric bilge pumps - 1 Manual bilge pump
- 1 Electric ice box drain pump

## GAS

- Gas bottle box in the cockpit (1 or 2 bottles, according to model)
- Regulator and safety tap



**TRIM LEVEL**

	<b>INSPIRATION</b>	<b>SENSATION</b>
Electronic - Starboard steering console: 1 Display T41 Graphic B&G (Loch, Speedometer, Depth sounder)	■	■
2rd Stem roller - Stainless steel bobstay	■	■
Cockpit sole natural solid wood	■	■
Sonic Hub + Speakers (BOSE ACOUSTIMASS 3) - Waterproof exterior speakers	■	■
Backrests to helm (Natte Stone)	■	■
4 Opening ports in galley and saloon windows	■	■
Panoramique window with pleated blinds	■	■
Galley: Sea water foot pump + Fresh water	■	■
Cockpit shower hot - Cold water	■	■
LED: Inside and outside lighting (except: Deck searchlight)	■	■
Indirect lighting - LED	■	■
2 Additional service batteries (2 x 110 Amperes - 12 V) + 2 (2 x 40 Amp) batteries chargers instead of 25 Amp	■	■
Textile storage with 2 steering consoles	■	■
Storage space(s) under the floor	■	■
Stainless steel beading for fenders in cockpit locker	■	■
1 Port electric coachroof winch H 40.2 STCEH		■
Chart table: Universal recharging station (Cellphone, GPS, PDA etc...)		■
Galley: 12V refrigeration unit in icebox with top opening - Freezer		■
Galley: Deluxe 3 burners hob, stainless steel oven and grill		■
Galley: Freshwater purifier		■
Pump for deck washing		■
Shore freshwater supply		■
12 V / 220 V inverter (2 000 W) + Voltmeter		■

**OPTION PACK**

	<b>DOCKING</b>	<b>EASY DOCKING</b> (NOT AVAILABLE WITH DOCK & GO)	<b>ELECTRONIC B&amp;G</b>
Bow thruster		■	
2 Steering wheels + Console white PVC covers	■	■	
Windlass control in cockpit with chain counter to starboard	■	■	
4 Mooring lines, Mooring, 6 Fenders	■	■	
Starboard steering console: Multifunction touchscreen B&G Zeus 9" wide (GPS - Chart plotter - Chart reader - Cartography Navionics Silver included)			■
To port steering console: 1 Display T41 Graphic B&G (Windvane, Anemometer)			■
Wifi interface			■

**VERSION**

	<b>DOCK &amp; GO</b>
YANMAR Diesel Dock & Go POD 90 engine	■
Swivel Sail Drive base	■
Joystick	■
Vessel Management Unit (VMU)	■
Bow thruster	■
Auto pilot	■

## OTHER OPTIONS

---

### NAVIGATION ELECTRONICS B&G

- AC42 autopilot + Control at steering station
- AIS 400 (Transmitter / Receiver)
- 4G Radar
- Port cockpit: Zeus 9" wide additional multifonction screen
- Chart table: Zeus 9" wide additional multifonction screen
- Chart table: Fixed B&G V50 VHF, function AIS receiver

### RIGGING - SAIL

- Flag halyards
- Asymmetric spinnaker rigging + Code 0 Rigging
- Releasable fore-stay chain-plate
- Anodized furling mast - Laminated polyester tri-radial mainsail
- Code 0 tri-radial cut polyester sail on furling gear
- Easy Sail for classical mast (Genoa sheets adjustable from the cockpit, Clutches on genoa sheet blocks, Backstay adjustment)
- Easy Sail for mast with in-mast furling (Genoa sheets adjustable from the cockpit, Clutches on genoa sheet blocks)

### WINCHES

- Coach roof winch to starboard H40.2 STC

### HULL - DECK

- Graphite Coachroof sprayhood
- Graphite Cockpit Bimini
- Natte Stone + Quadri Grey outside upholstery
- Blue-grey hull - Pearl white livery
- Grey "Perle" hull - Matte black hull decoration
- Windex Windvane
- Solid wood slatted catwalks
- 2 White composite steering wheels
- 3 retractable blades propeller

### INTERIOR EQUIPMENT

- Water maker 60 l/h / 16 US Gal/hour 12 V/220 V
- Extra water tank (160 l / 42 US Gal Saloon)
- Additional 200 l / 53 US Gal diesel tank (Port aft)
- 6 kVA 220 V / 50 Hz Generator - with cocoon
- Deluxe saloon table on foot with manually adjustable height
- 220V Microwave oven
- 220 V Dishwasher
- Extractor hood
- Forced air heating fuel
- Chilled water air-conditioning unit 220V
- Head board(s) for the forward cabin, Rodeo Snow Cushions
- Double berth in saloon
- Lathed bed bases in all cabins
- Carpet kit (Pure Sand)
- Electric toilet
- TV LED 32" folding + Player Fusion (Bluetooth, USB, Dvd, MP3), in the saloon
- Grey upholstery padding in all cabins or Taupe
- Light white oak laminate floors

